



# FIRESTOP CENTRE

Authorised New Zealand Distributor  
Ph (09) 483 4000 www.firestopcentre.co.nz

## FIRESTOP Duct Wrap-38 Rectangular Duct (up to 1800 x 1000mm) Plasterboard Wall (from 1x13mm) Internal or External Fire

**FireTS Lab**

Report AR23108, Pages 9 - 11, 25 - 29  
AS1530.4-2014 AS4072.1-2005

System ID# FC107

<b>Products</b>	FIRESTOP Duct Wrap-38 Protecta FR Board Protecta FR Acrylic or FIRESTOP Ultra
<b>Application</b>	Fire stopping of rectangular duct through a F/R plasterboard wall
<b>Construction</b>	1x13mm - 64mm steel or 90mm timber stud 2x13mm - 90mm steel or timber stud

### Fire Classification

NOTE: For general instructions on installing FIRESTOP Duct Wrap-38 see [Installation Instructions](#) sheet on Firestop Centre website.

#### Internal Fire Only:

Single layer wrap	FRR 120/120/30
Add 1400mm second layer	FRR 120/120/60
Add 1900mm second layer	FRR 120/120/120

#### External and Internal Fire:

Single layer wrap	FRR 60/60/30
Double layer wrap	FRR 120/120/120

NOTE: Where the FRR of the wall is less than the FRR of the above system, the system FRR is reduced to match the wall.



**FIRESTOP**

Firestop Centre Ltd  
657 Great South Road  
Penrose, AUCKLAND

Sheet size: <b>A4</b>	Drawn date & no: 20/5/24
--------------------------	-----------------------------

### INSTALLATION INSTRUCTIONS

- Aperture must be framed and lined to match the wall. Annular gap 10 - 30mm.
- Sealants permitted for this system are Protecta FR Acrylic or FIRESTOP Ultra. Either may be used.
- Place unfoiled Firestop Duct Wrap material compressed nominally 30% into the annular gap leaving a 20mm recess each side. Ensure any gaps in corners, etc are filled to the required compression.
- Fill the recess with 20mm deep sealant to each side of the wall. Then apply a bead of sealant to the duct and the wall prior to attaching the angle.
- Attach 1.2mm thick steel angle 75mm x 75mm to all sides. Fix to the duct with steel rivets 10mm x 5mm diam at max 100mm centres. Fix to the wall with plasterboard screws (min 32mm) at max 200mm centres high enough to clear the annular space. Ensure a fixing at max 50mm from each end of an angle section. Apply sealant to any joints or corner gaps.
- Apply a bead of sealant to each face of the angle. Construct a collar minimum 130mm high from Protecta FR Board (60mm 2-sided) and fix directly to the wall with 8-10g x 75mm screws with penny washers at 200mm centres (passing above the steel angle). Ensure a fixing at max 50mm from the end of each frame section.
- Fill any joints in the collar with sealant. Then apply a 20mm sealant fillet at the wall/collar joint and the duct/collar/angle joint. Finally cover the exposed cut edges of the collar with sealant or Protecta FR Coating.
- Install the Firestop Duct Wrap layers as specified and apply a sealant fillet at the wrap/collar junction.

NOTE: Diagram shows 2 layer system, but see details on right for number of layers

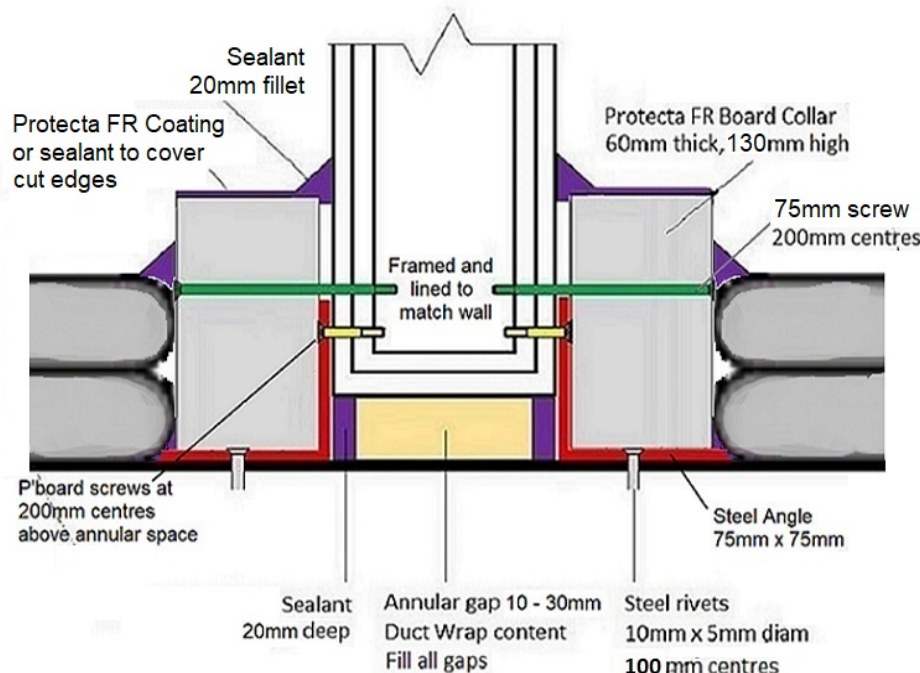

As a part of our policy of on-going product development and testing, we reserve the right to modify, alter or change product specifications without giving notice. All information contained in this document is given in good faith and is provided for guidance only. Any drawings provided are for illustrative purposes only. As Firestop Centre has no control over the methods or competence of installation and of prevailing site conditions, no warranties, expressed or implied are intended to be given as to the actual performance of the product mentioned or referred to herein and no liability whatsoever will be accepted for any loss, damage or injury arising from the use of the information given.